



MOUNT ERRIGAL HOTEL
Letterkenny
Co.Donegal

Located along the Wild Atlantic Way, County Donegal, The Mount Errigal Hotel boasts an impressive range of facilities that have contributed to making it one of the top business conference destinations.

The Mount Errigal Hotel, Conference and Leisure Centre a superior 3* hotel combines state of the art facilities, spacious and deluxe accommodation, fine cuisine with a friendly and professional environment.

Featuring 9 conference and meeting rooms catering for numbers from 10 to 1000 guests. Throughout your event a dedicated member from our conference & banqueting team will ensure your event exceeds your expectations.

The Mount Errigal Hotel Letterkenny is a renowned leader in hosting a wide range of corporate functions in Donegal, such as:

- Annual General Meetings
- Exhibitions
- Trade Fairs
- National & International Conferences
- Training Courses
- Recruitment Events
- Interviews
- Board Meetings
- Celebration Dinner Dances
- Gala Dinners
- Cocktail Parties

Our experienced team consists of a mix of conference and event organisers ensuring that each event runs successfully and are delighted to advise on all options available, ensuring that all requirements are met.



Corporate

As the premium hotel in Errigal Hotel offers

chance to experience superior conferencing and meeting rooms facilities accompanied by beautifully appointed guestrooms, state of the art leisure centre all mixed together in the perfect central location. Corporate packages can be tailored as required to incorporate room hire, dining/banqueting, accommodation and full use of our leisure facilities.

For more information on corporate packages available please contact our Conference & Banqueting team info@mounterrigan.com

Packages

Letterkenny, the Mount corporate guests the

The Glenveagh



MOUNT ERRIGAL HOTEL
Letterkenny
Co.Donegal

Suite

The Glenveagh Suite is one of the largest conference venues in the North West of Ireland. It can be portioned into two rooms that provide their own set of facilities.

one of the largest North West of Ireland. It

1. Executive Décor & Seating
2. High Speed Wireless Internet
3. Staging
4. Built in Sound System
5. PA Control
6. Screen & Over Head Projector
7. Full Air Conditioning
8. Two Private Bars
9. Dance Floor
10. Wheelchair Accessible

Capacity

- Theatre: 1000
- Boardroom: Any Number
- Classroom: 400
- U- Shape: Any Number
- Banquet Full Room: 560
- Banquet (Dance Floor Clear): 500

Room Dimensions

Area: m2 825
Length: 37.5m
Breadth: 22m

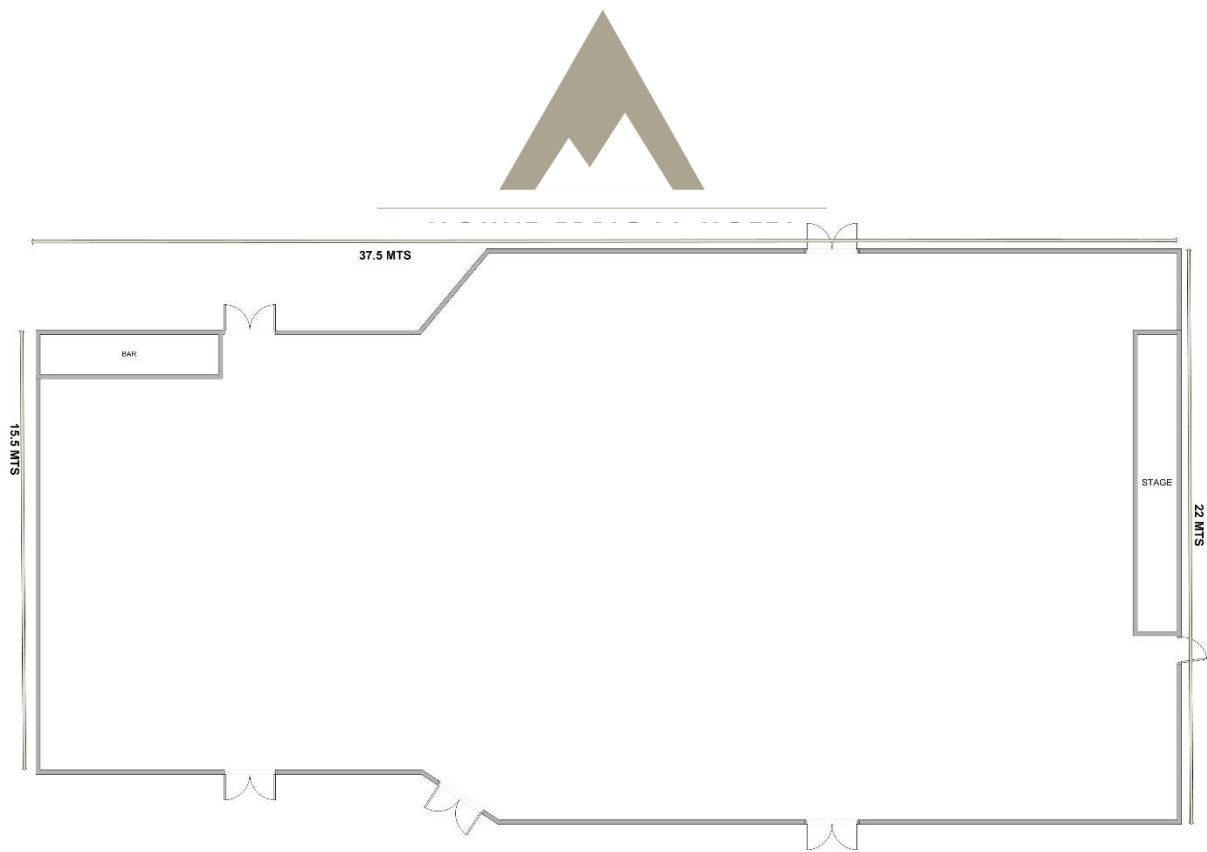

Glencar Room

A sub partition of The Glenveagh Suite offering the same facilities on a smaller scale.

1. Executive Décor & Seating
2. High Speed Wireless Internet
3. Portable Stage
4. Built in Sound System
5. PA Control
6. Screen & Over Head Projector
7. Full Air Conditioning
8. Private Bar
9. Wheelchair Accessible

Capacity

- Theatre: 200
- Boardroom: 60
- Classroom: 80
- U- Shape: 40
- Banquet Full Room: 150
- Banquet (Dance Floor Clear): 120

Room Dimensions

Area: m² 240
 Length: 15.5m
 Breadth: 15.5m



MOUNT ERRIGAL HOTEL
Letterkenny
Co.Donegal



Glendowan Room

MOUNT ERRIGAL HOTEL
Letterkenny
Co.Donegal

A sub partition of the
its own stage and dance
and large-scale events.

Glenveagh Suite, offering
floor. Perfect for medium

1. Executive Décor & Seating
2. High Speed Wireless Internet
3. Stage & Dance Floor
4. Built in Sound System
5. PA Control
6. Screen & Over Head Projector
7. Full Air Conditioning
8. Private Bar
9. Wheelchair Accessible

Capacity

- Theatre: 600
- Boardroom: Any Number
- Classroom: 180
- U- Shape: Any Number
- Banquet Full Room: 300
- Banquet (Dance Floor Clear): 250

Room Dimensions

Area: m2 282
Length: 12.8m
Breadth: 22m



Great Room

MOUNT ERRIGAL HOTEL
Letterkenny
Co.Donegal

The Great Room offers beams, a private bar with daylight. Perfect for Banquet dining and large corporate events.

rustic exposed wooden an abundance of natural

1. Executive Décor & Seating
2. Natural Daylight
3. High Speed Wireless Internet
4. Stage & Dance Floor
5. Built in Sound System
6. PA Control
7. Private Bar
8. Full Air Conditioning
9. Wheelchair Accessible

Capacity

- Theatre: 600
- Boardroom: Any Number
- Classroom: 300
- U- Shape: Any Number
- Banquet Full Room: 300
- Banquet (Dance Floor Clear): 250

Room Dimensions

Area: m2 282
Length: 12.8m
Breadth: 22m



Knockalla Suite

MOUNT ERRIGAL HOTEL
Letterkenny
Co. Donegal

Ideal for smaller functions, this suite

and a small stage. It can be partitioned into two rooms that are perfect for meetings or as a meals and refreshments area.

conferences and features natural daylight

1. Executive Décor & Seating
2. Natural Daylight
3. 60" Interactive TV
4. High Speed Wireless Internet
5. Stage & Dancefloor
6. Private Bar
7. Full Air Conditioning
8. Wheelchair Accessible

Capacity

- Theatre: 180
- Boardroom: 60
- Classroom: 100
- U- Shape: 50
- Banquet Full Room: 150
- Banquet (Dance Floor Clear): 120

Room Dimensions

Area: m2 220
Length: 22m
Breadth: 10m



Knockalla Room

MOUNT ERRIGAL HOTEL
Letterkenny
Co.Donegal

A small private function
The Knockalla Suite.

room that is a division of

1. Executive Décor & Seating
2. Natural Daylight
3. Stage & Dance Floor
4. 60" Interactive TV
5. High Speed Wireless Internet
6. Stage & Dance Floor
7. Full Air Conditioning
8. Wheelchair Accessible

Capacity

- Theatre: 70
- Boardroom: 35
- Classroom: 30
- U- Shape: 30
- Banquet Full Room: 60

Room Dimensions

Area: m2 137
Length: 13.7m
Breadth: 10m



Glengesh Room

MOUNT ERRIGAL HOTEL
Letterkenny
Co. Donegal

A small private function
The Knockalla Suite.

room that is a division of

1. Executive Décor & Seating
2. Natural Daylight
3. Stage & Dance Floor
4. 60" Interactive TV
5. High Speed Wireless Internet
6. Stage & Dance Floor
7. Full Air Conditioning
8. Wheelchair Accessible

Capacity

- Theatre: 70
- Boardroom: 35
- Classroom: 30
- U- Shape: 30
- Banquet Full Room: 60

Room Dimensions

Area: m2 82
Length: 8.2m
Breadth: 10m



Aranmore Room

MOUNT ERRIGAL HOTEL
Letterkenny
Co.Donegal

Within easy access of our
the Aranmore room can

purposes or as an extra to a main event. Ideally used for board meetings, interviews, training
courses etc.

main conference suites,
be used for a variety of

1. Executive Décor & Seating
2. 60" Interactive TV
3. High Speed Wireless Internet
4. Full Air Conditioning
5. Wheelchair Accessible

Capacity

- Theatre: 40
- Boardroom: 20
- Classroom: 20
- U- Shape: 16

Room Dimensions

Area: m2 69
Length: 9.1m
Breadth: 7.6m



MOUNT ERRIGAL HOTEL
Letterkenny
Co.Donegal

Inishfree Room

Located beside the easy access of our main used for board meetings and interviews.

Aranmore room within conference suites. Ideally

1. Executive Décor & Seating
2. 60" Interactive TV
3. High Speed Wireless Internet
4. Full Air Conditioning
5. Wheelchair Accessible

Capacity

- Theatre: 30
- Boardroom: 16
- Classroom: 12
- U- Shape: 12

Room Dimensions

Area: m2 34
Length: 6.7m
Breadth: 5.1m

Conference



MOUNT ERRIGAL HOTEL
Letterkenny
Co. Donegal

Refreshments

Tea/Coffee

Tea/Coffee & Biscuits

Tea/Coffee & Scones

Tea/Coffee & Sandwiches

Soup & Sandwiches

Soup/Sandwiches/ Tea & Coffee

Finger Food (5 Items)

Finger Food (7 Items)

Main Course with Tea & Coffee

Main Course, Dessert with Tea & Coffee

We cater for all dietary requirements, please inform our conference and banqueting manager who will give you a comprehensive list of alternatives for any attendees with dietary requirements.